

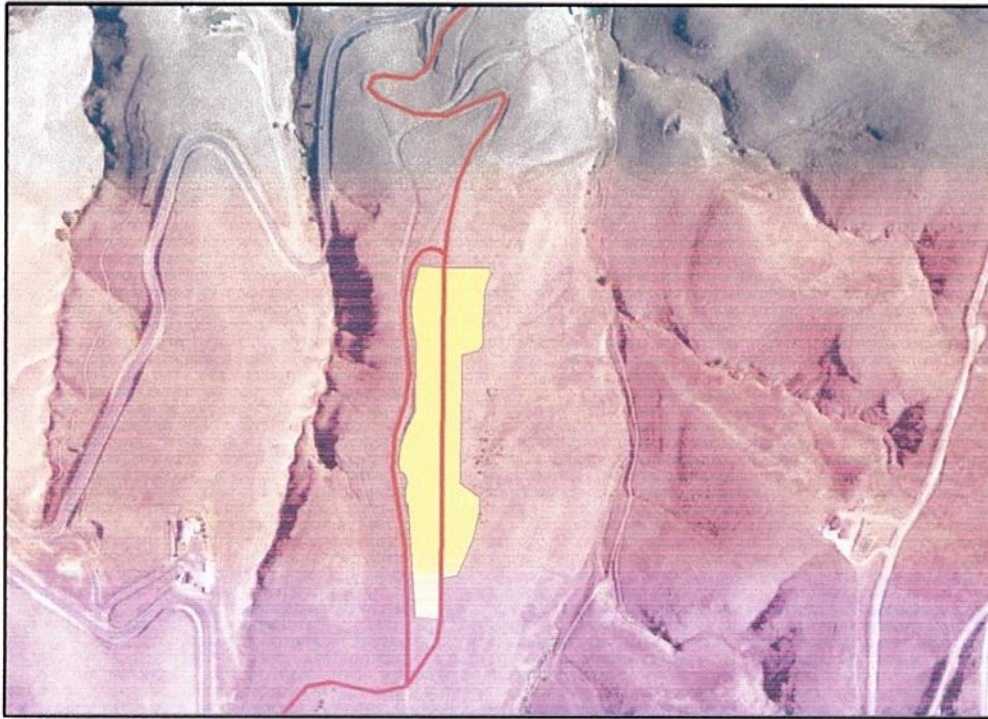



Asotin Cemetery



Legend



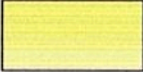
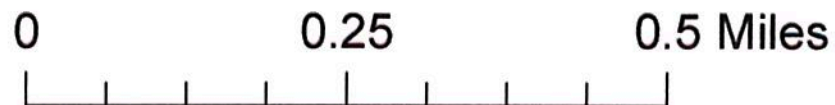
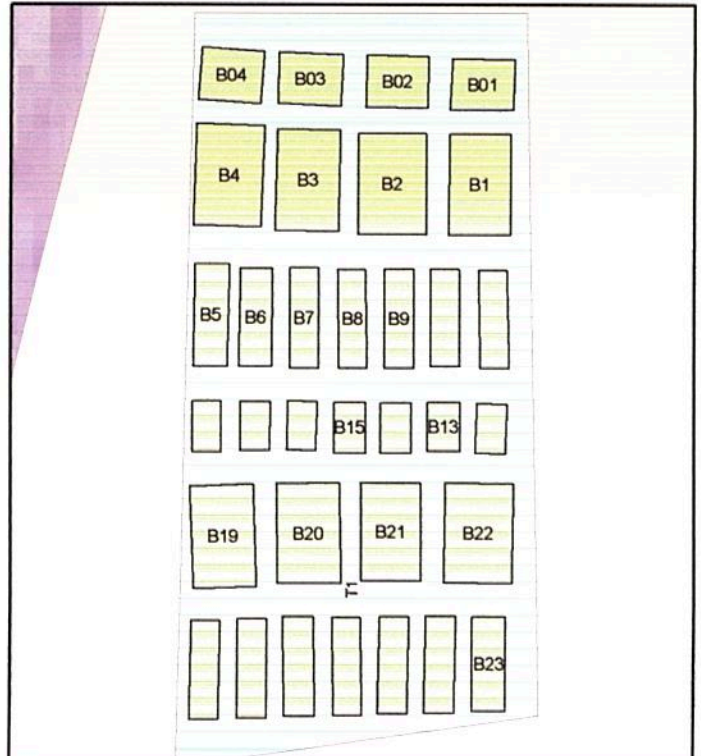
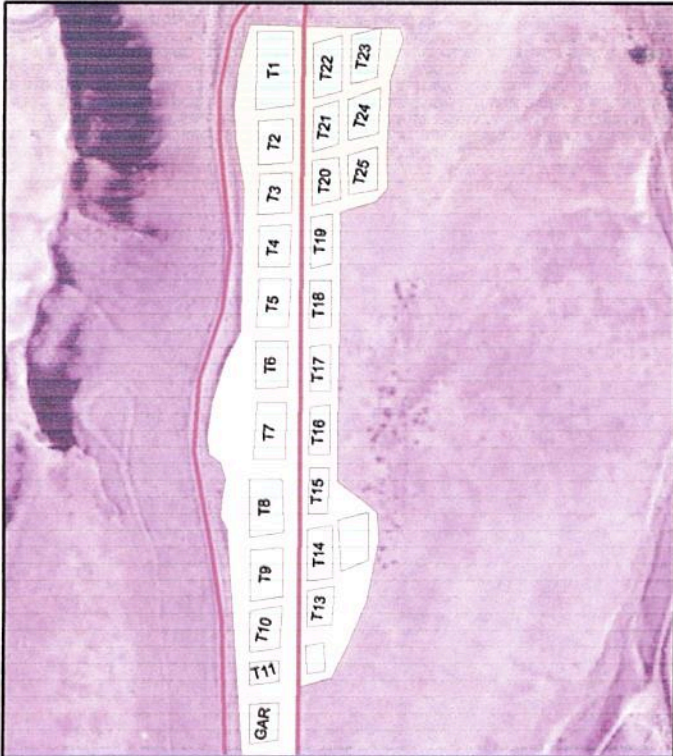

-  Roads
-  Cemetery
-  Tracts
-  Blocks

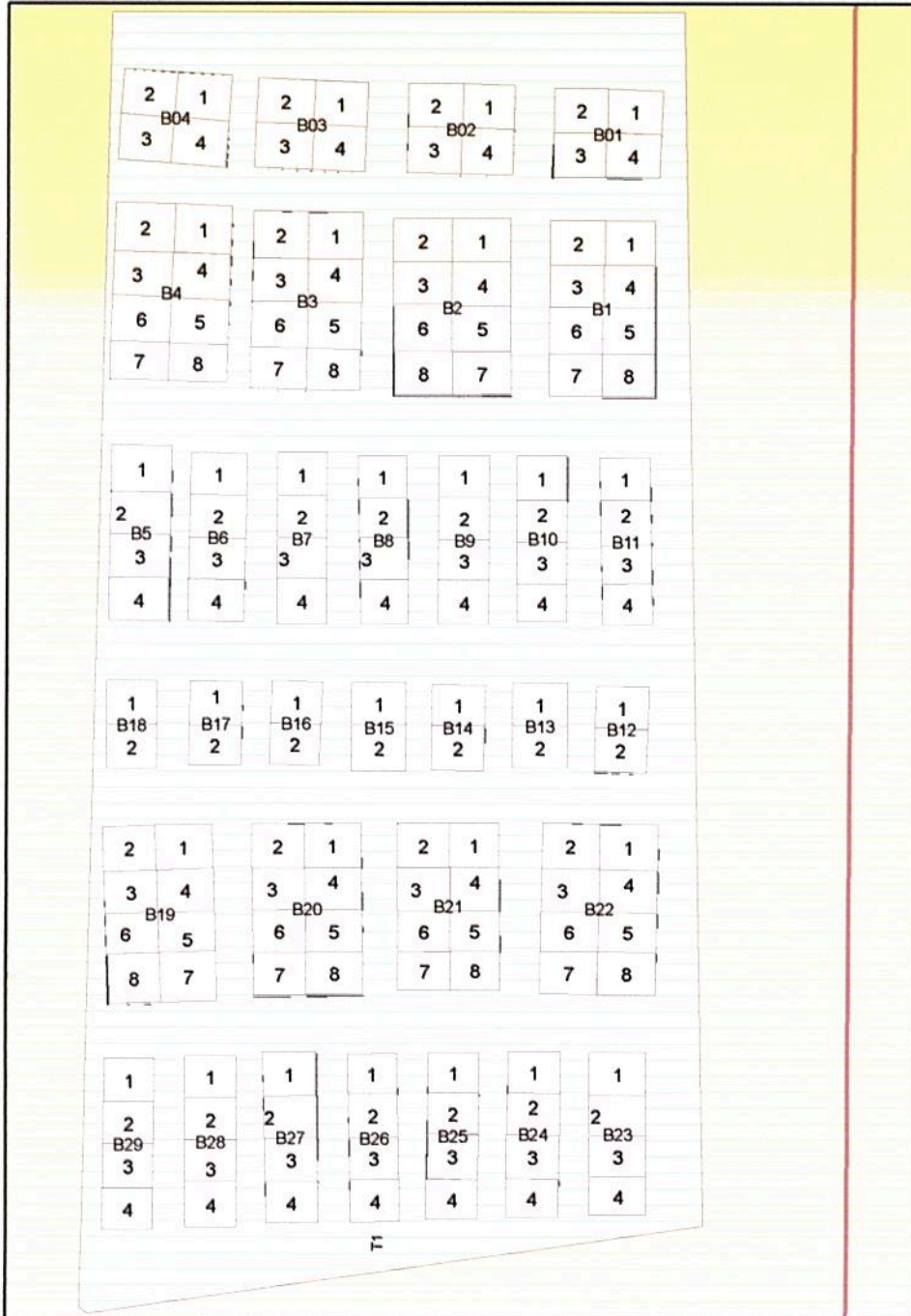

Tract 1 Blocks B01-B29 Lots 1-8

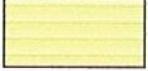

Legend

-  Roads
-  Lots
-  Blocks
-  Tracts
-  Cemetery

0 0.0065 0.013 Miles



Asotin Cemetery



Head South on
Cleveland St.
Turn Left on
Fairgrounds Rd.
Turn Right on
to WA-129,
for 1.6 miles.
Turn Left on to
Cemetery Rd.
You can also
take Cemetery Rd.
when only .1 mi
on WA-129.
The dirt road
is gated though.

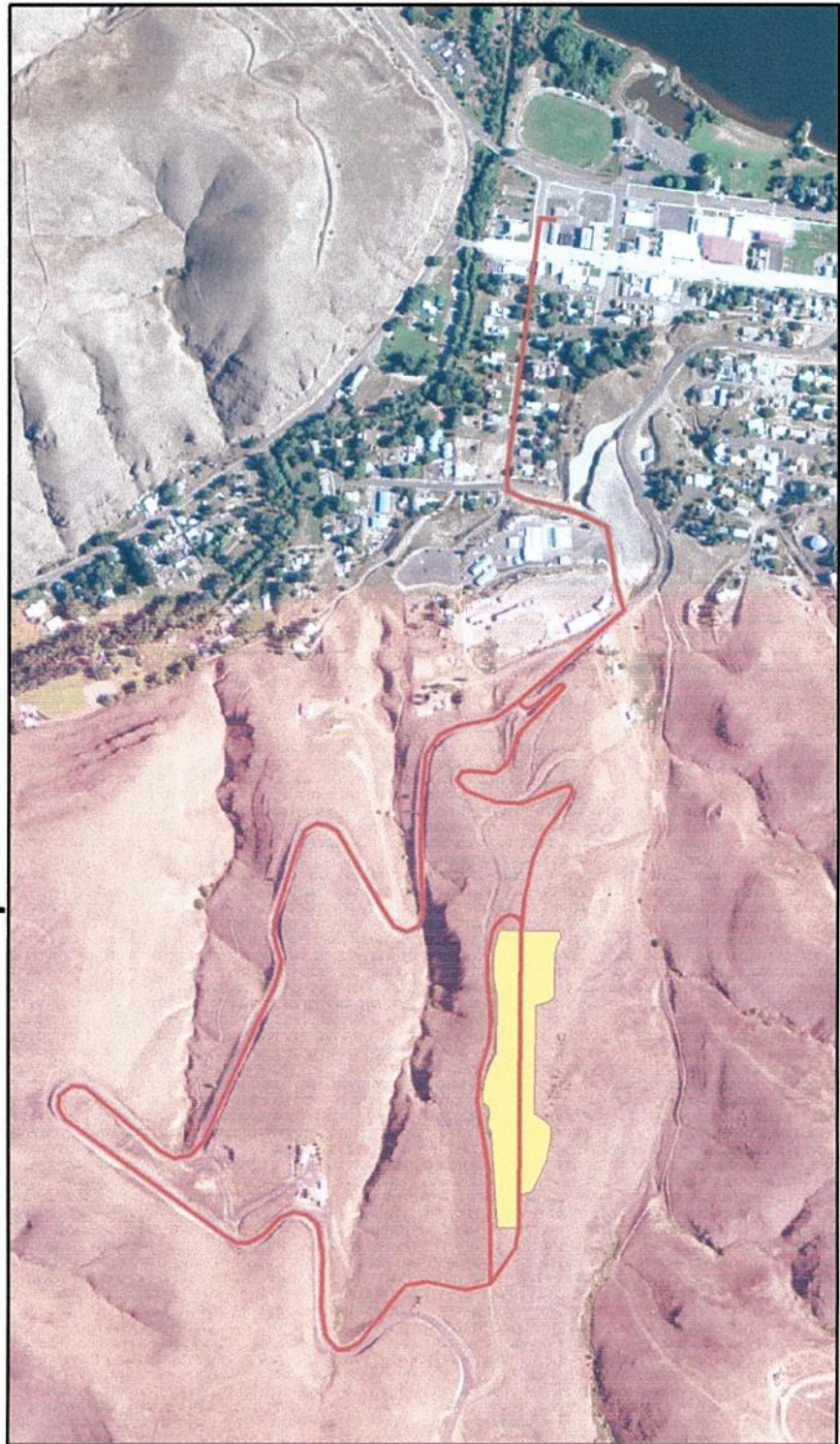

Legend

-  Roads
-  Cemetery

